

SYMBOL LEGEND:

— x —	FENCE LINE	—	RETAINING WALL
— SS —	SEWER MAIN	— PG&E —	PG&E BOX
— W —	WATER MAIN	— GM —	GAS METER
— G —	GAS MAIN	— TB —	TELEPHONE BOX
— ETC —	ELEC/TELEPHONE/CABLE	— SB —	SIGNAL BOX
— OHE —	OVERHEAD ELECTRIC	— CTV —	CABLE T.V. BOX
—	DROP INLET AT CURB	— EB —	ELECTRIC BOX
—	DROP INLET	— TMH —	TELEPHONE MANHOLE
—	STORM DRAIN MANHOLE	— SL —	STREET LIGHT
—	FIRE HYDRANT	— JP —	JOINT POLE
—	WATER WELL	— PP —	POWER POLE
—	WATER VALVE	— GW —	GUY WIRE
—	WATER METER	— R1 —	A M D 169
—	SEWER MANHOLE	— M —	MEASURED
—	SEWER CLEANOUT	— SP —	SINGLE PROPORTION
—	MONITORING WELL	— PTR —	PRELIMINARY TITLE REPORT
		— N'LY —	NORTHERLY
		— S'LY —	SOUTHERLY
		— E'LY —	EASTERLY
		— W'LY —	WESTERLY
		— P/L —	PROPERTY LINE

**ALTA/NSPS
LAND TITLE SURVEY**

LOTS 1 AND 2 IN BLOCK 42, LOTS 1 THROUGH 4, 7, AND 8 ALONG WITH A PORTION OF LOTS 5 AND 6 OF BLOCK 31 IN THE CITY OF PASO ROBLES, COUNTY OF SAN LUIS OBISPO, STATE OF CALIFORNIA

AT THE REQUEST OF PASO ROBLES PINE STREET LLC

MBS LAND SURVEYS
MICHAEL B. STANTON, PLS 5702
3559 SOUTH HIGUERA ST.
SAN LUIS OBISPO, CA 93401
805-594-1960

SHEET 2 OF 2 October 29, 2018 JOB #18-271

TP-01

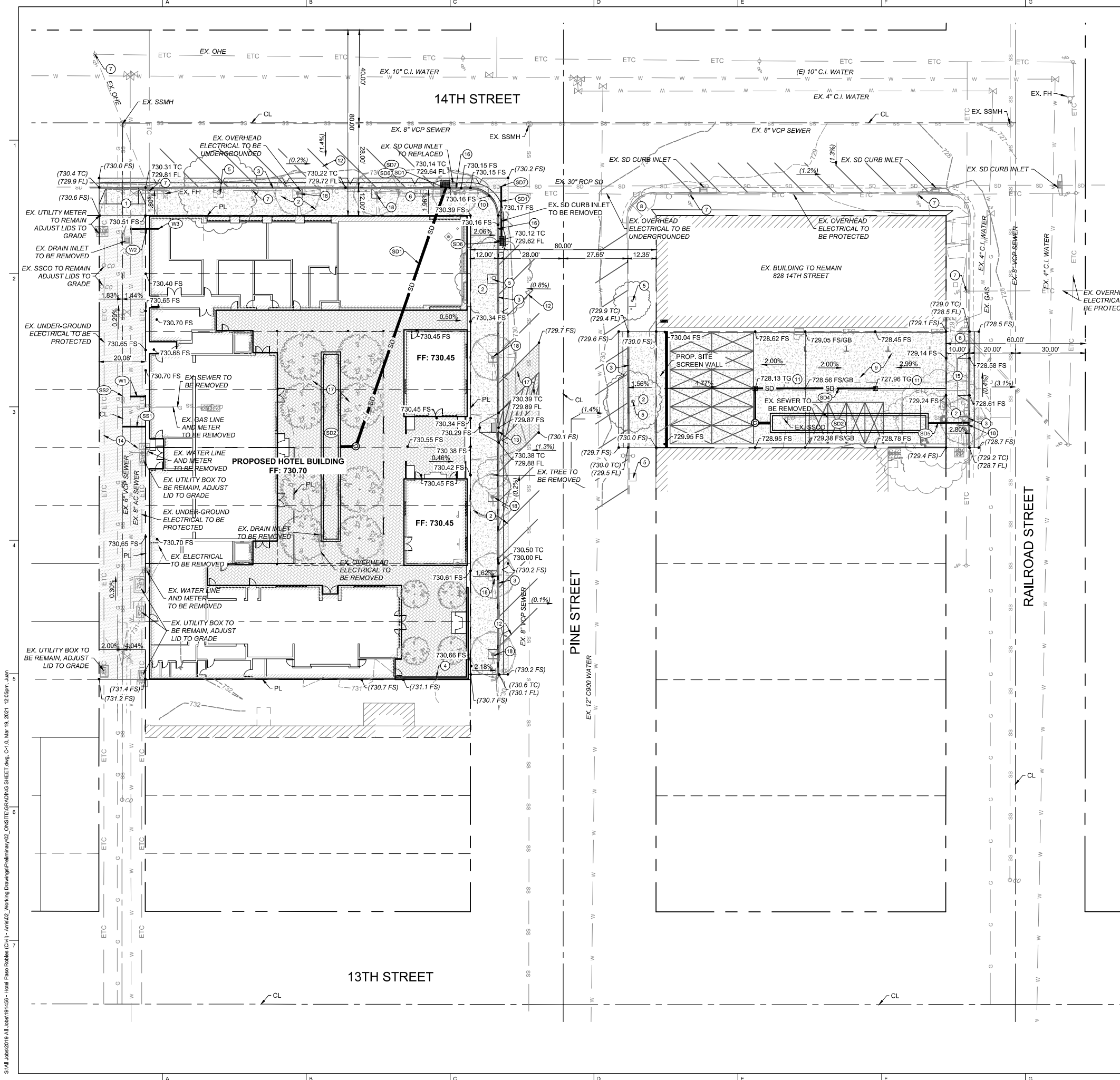

- SITE CONSTRUCTION NOTES:**
- 1 EXISTING ALLEY APPROACH TO BE REMOVED AND REPLACED PER CITY OF PASO ROBLES STANDARD C-5
 - 2 EXISTING SIDEWALK TO BE REMOVED AND REPLACED PER CITY OF PASO ROBLES STANDARD C-4
 - 3 EXISTING CURB AND GUTTER TO BE REMOVED AND REPLACED PER CITY OF PASO ROBLES STANDARD C-1 AND C-7
 - 4 EXISTING SITE WALL TO BE REMOVED
 - 5 EXISTING TREE TO BE PROTECTED IN PLACE
 - 6 EXISTING DRIVEWAY APPROACH TO BE REMOVED
 - 7 EXISTING UTILITY POLE
 - 8 EXISTING CURB RETURN
 - 9 CONSTRUCT CONCRETE PAVEMENT
 - 10 CONSTRUCT CURB RAMP FLUSH WITH INTERSECTION
 - 11 INSTALL DRAIN INLET WITH TRAFFIC RATED LID
 - 12 INSTALL STREET PARKING STRIPING
 - 13 CONSTRUCT ADA CURB RAMP
 - 14 CONSTRUCT ALLEY PER CITY OF PASO ROBLES STANDARD A-7
 - 15 CONSTRUCT DRIVEWAY APPROACH PER CITY OF PASO ROBLES STANDARD C-9
 - 16 INSTALL 5 L6 6" TO 0" CURB TRANSITION
 - 17 PROPOSED PAVER SURFACE
 - 18 PROPOSED STREET TREE

- STORM DRAIN CONSTRUCTION NOTES:**
- (SD1) CONSTRUCT STORM DRAIN PIPE
 - (SD2) CONSTRUCT STORMWATER CHAMBERS
 - (SD3) NOT IN USE
 - (SD4) CONSTRUCT STORM DRAIN PIPE
 - (SD5) CONSTRUCT STORMWATER PIPE OVERFLOW THROUGH SIDEWALK UNDERDRAIN
 - (SD6) CONSTRUCT DRAINAGE INLET PER CITY OF PASO ROBLES STANDARD D-1 MODIFIED WITH NO CURB OPENING.
 - (SD7) STORMDRAIN CONNECTION POINT TO EXISTING STORMDRAIN SYSTEM.

- SANITARY SEWER CONSTRUCTION NOTES:**
- (SS1) PROPOSED SEWER LATERAL WITH BACKFLOW PREVENTER
 - (SS2) REPLACE EXISTING 6" SEWER WITH 8" SEWER LINE UPSIZE FROM LATERAL CONNECTION TO SEWER MAIN.

- WATER CONSTRUCTION NOTES:**
- (W1) PROPOSED DOMESTIC WATER LINE AND METER
 - (W2) PROPOSED FIRE WATER LINE
 - (W3) PROPOSED DDCA LOCATED INSIDE UTILITY ROOM

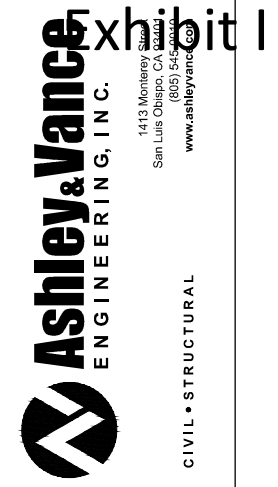

The use of these plans and specifications shall be restricted to the original site for which they were prepared and publication thereof is expressly limited to such use. Reproduction or publication by any method, in whole or in part, is prohibited. Title to these plans and specifications remain with Ashley & Vance Engineering, Inc. without prejudice. Visual contact with these plans and specifications shall constitute prima facie evidence of the acceptance of these restrictions.

HOTEL PASO ROBLES
 -PRELIMINARY PLANS-
1315 & 1344 PINE STREET
PASO ROBLES, CA 93446

Revisions:

Project Engineer: JMA Ext: 156
 Project Manager: KBB
 Date: 03.09.2021 Scale: PER PLAN
 AV Job No: 191456 Sheet Size: 24" x 36"

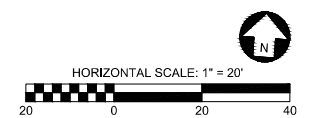
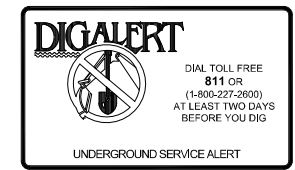

PRELIMINARY GRADING AND UTILITY PLAN
C-1.0

S:\11 Jobs\2019 All Jobs\191456 - Hotel Paso Robles (C-1) - Aris\02 - Working Drawings\Preliminary\02 - PRELIMINARY\02 - GRADING SHEET.dwg, C-1.0, Mar 19, 2021, 12:05pm, jman