

# FLOOR PLAN NOTES

NOTE: Refer to code sections referenced for minimum requirements, and plans, schedules, sections, elevations, and details for specific configurations of items listed below.

- DISCREPANCIES/REVISIONS:** Notify Architect of any discrepancies or proposed revisions to dimensions shown prior to proceeding with work.
- WALL FRAMING:** 600s125-33 or 3625s125-33 steel studs, 16" o.c. (2x4 K.D. Douglas Fir or Spruce @ bar). Refer to details and sections for attachment to existing horizontal framing. Material shall be straight without warp or twists.
- BLOCKING:** Refer to Interior Elevations, Details, Plumbing Plan and other pertinent sheets to locate blocking as required for attachment of rails, fixtures, shelving, Cabinets and other devices. Refer to detail 14/A8.3 for general blocking. Use 4x blocking at locations where items require attachment to the wall. Provide blocking at all sinks, cabinets, shelves & elsewhere as appropriate. If straps are used in lieu of solid wood blocking, straps must be on both sides of metal studs framing to prevent twisting and bending. Photograph blocking locations prior to walls being covered for future reference. Provide fire blocking as required in UBC 708 using 2x solid blocking or other approved material.
- EXITING:** Comply with all requirements of CBC, Chapter 10, for protection of exits, width of exits, number of exits, location of exits, travel distance in exits, travel distance to exits, accessibility to exits and other requirements as noted. Refer to Egress Plan for additional information.
- ACCESSIBILITY:** Comply with all requirements for Accessibility as addressed in ADA (guides and manuals), CBC 1007, CBC Chapter 11B, CBC Accessibility diagrams. Refer to Egress plan for additional information.
- RESTROOMS:** Sanitary facilities that serve buildings, facilities or portions of buildings or facilities that are required to be accessible to persons with disabilities shall be on accessible route and shall conform to CBC 1115B. Restroom for this project have been previously approved (City of Paso Robles Plan Check NO. B12-0241)
- FIRE PROTECTION:** Flame Spread Classifications for wall and ceiling materials shall not exceed the classifications listed in CBC Chapter 8, Table 803.5. Protection of construction elements shall be as required in CBC for a Type VB, sprinklered building. The space is to be equipped with a Sprinklered Fire Suppression System in accordance with NFPA Chapter 7 and CBC 903.3.
- PENETRATIONS & JOINTS:** Joints and other openings in the building envelope that are potential sources of air leakage shall be caulked, gasketed, weather-stripped or otherwise sealed to limit infiltration and exfiltration (CdNC 117).
- FINISHES:** See note 4 above for fire protection requirements. Walls- Unless otherwise noted all wall and ceiling finishes shall be of 5/8" type x gypsum board installed according to requirements of USGA for nailing, screw and joint treatment. Install wonder board or equivalent cementitious board around wet areas at back bar to receive tile. Walls at back bar area shall have a six inch covered tile or covered resilient flooring base. Covered resilient flooring base shall include continuous shaped backer strips to support the covered radius at the corner. Floors- Ground and floor surfaces along accessible routes and in rooms and spaces, including floors, walks, ramps, stairs, and curb ramps shall be stable, firm and slip-resistant (CBC 1124B & 1120B.2). Floor finishes shall be of the following material (where shown on Material Floor Plan).  

Hardwood	as selected by owner
Tile	quarry tile (non-slip)
Resilient Flooring	Armstrong, (non-slip)
Vinyl Tile	Burke, Luxury Solids
Accessories	
transition strip	Armstrong V17
snap down track	Armstrong V9
wall cover channel	Armstrong
Ceiling-	at roof shall have a black fabric scrim cloth. Refer to interior elevations and details for additional information on finishes.
- INSULATION:** Install insulation at all framed exterior and party walls. R-30 insulation has previously been installed at ceiling. Use types noted as follows:  
 R-13 high density at framed 2x4 walls  
 R-19 high density at framed 2x6 walls  
 R-30 at framed floors and ceilings

All work shall be tight fitting and snug using full length batts where ever possible. Provide insulation in framing between bedrooms, bathrooms and adjacent spaces. Below floor insulation shall be supported in place with netting or wire spaced not more than 24" o.c. Paper faced insulation is not allowed. Foil faced insulation shall be non flammable with face exposed to the room. Ceiling insulation shall be placed between framing. Ceiling insulation at juncture with wall shall allow for passage of air when next to a attic vent. Do not place insulation between rafter framing unless specifically noted on plans. Roof insulation when used shall be rigid insulation placed over osb. When recommended, provide rigid insulation of a type and thickness recommended by metal roofing manufacturer. Mandatory measures noted on T-24 sheets (ENV-MM), if more stringent, take precedent over items listed herein.

- TOLERANCES:**
  - Maximum variation of surface flatness for exposed concrete floor 1/8 inch in 10 feet.
  - Maximum variation of surface flatness under seamless resilient flooring 1/8 inch in 10 feet.
  - Maximum variation of surface flatness under carpeting 1/8 inch in 10 feet.
  - Maximum variation of surface flatness under wood flooring 1/8 inch in 20 feet.

**Note: applicant has proposed usage of existing dimensions and floor plan used by Taste in the Alley, as provided within this Exhibit.**

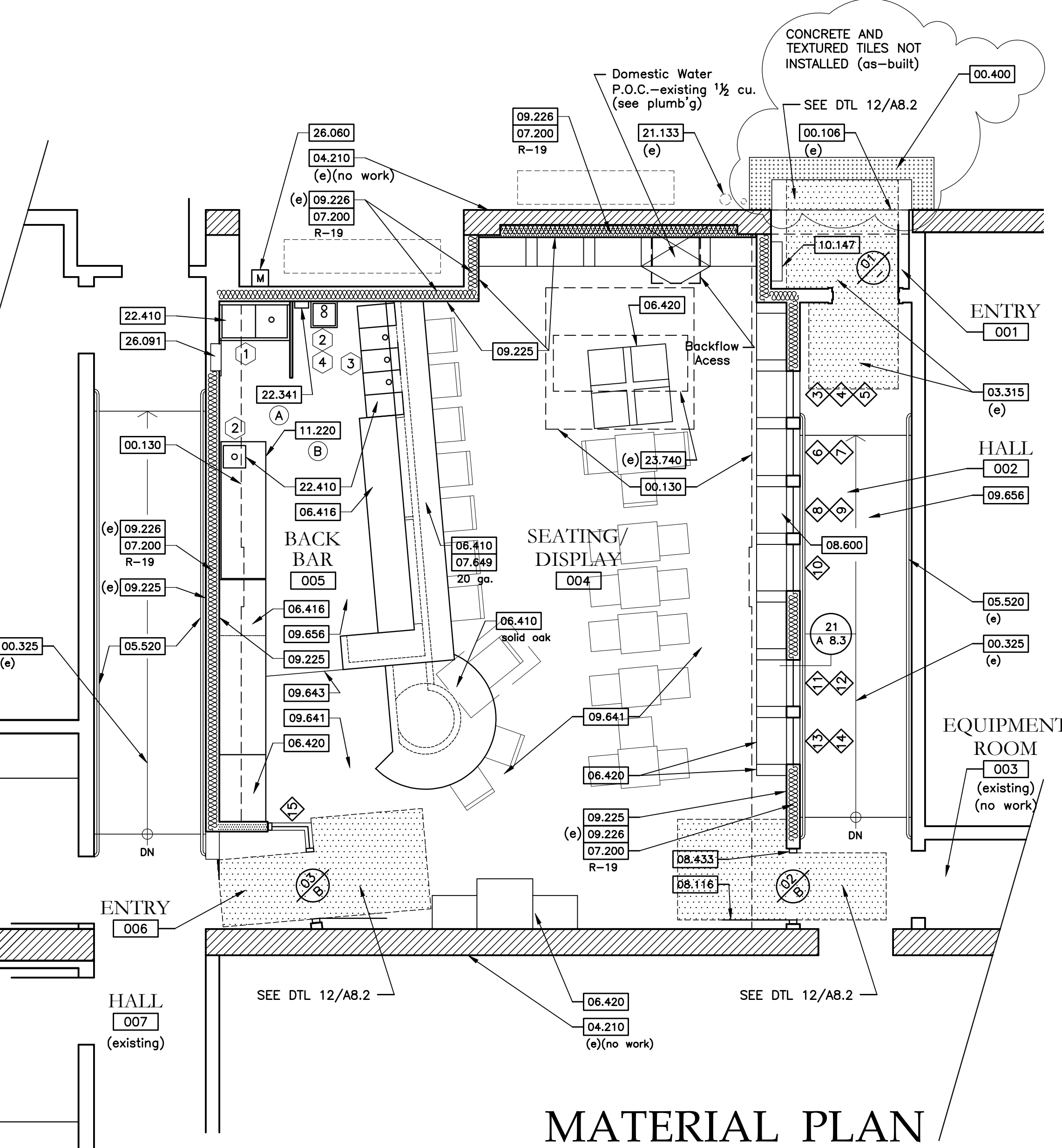

**MATERIAL PLAN**

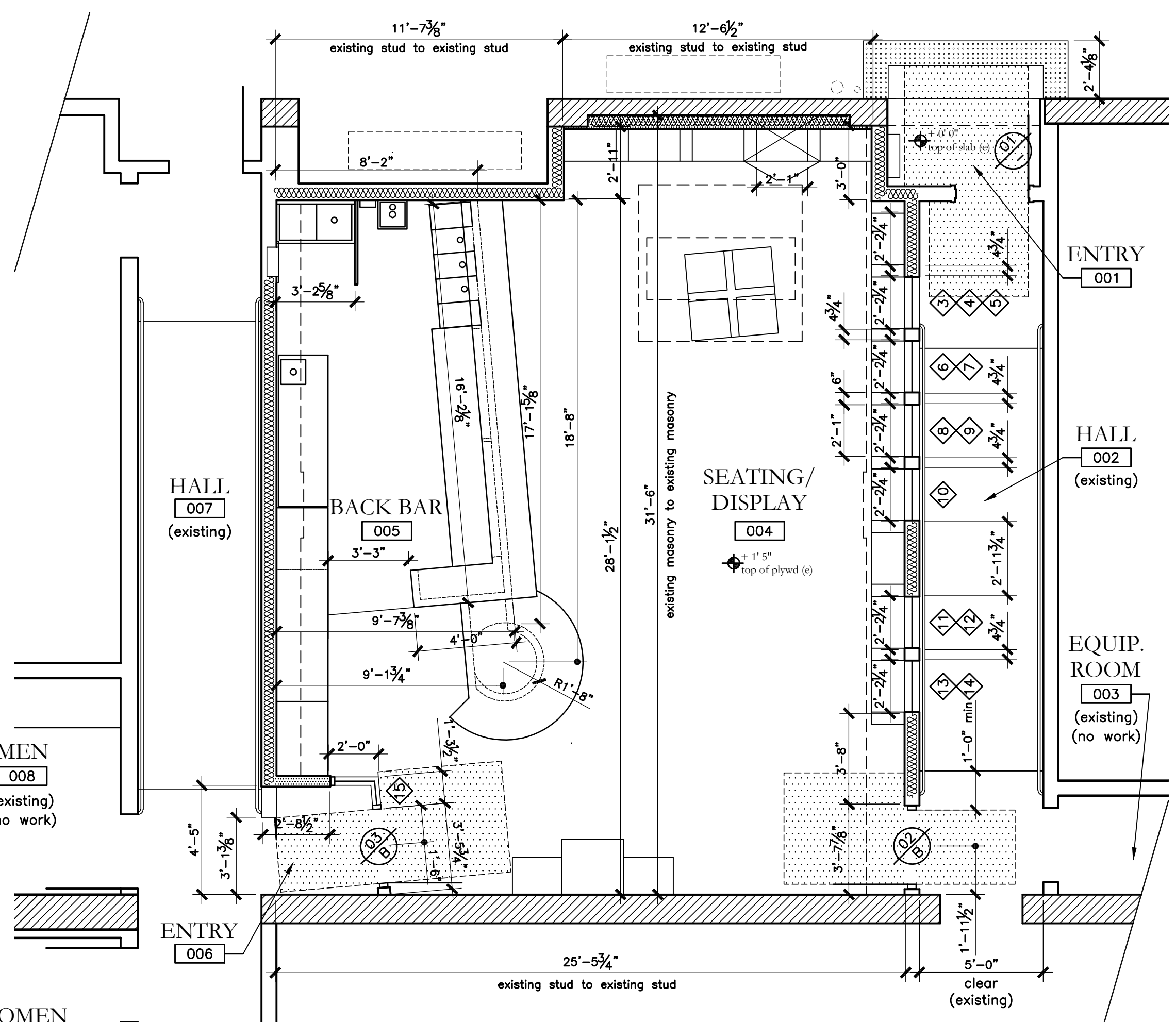

**DIMENSION PLAN**

**PLUMBING & APPLIANCE SCHEDULE**

MARK	ITEM	QNTY.	MANUFACTURER	MODEL NO.	SIZE OF APPLIANCE	TYPE	DEMAND	FINISH	OUTLET HT/SIZE	NOTES
					width X height X depth					
(X)	Xxxxx	x	Xxxxxxx	xxxxxxx	x-x X x-x X x-x	xxxxx	xxxxxx	-	-	
1	3 Compartment Sink	1	Glaesender	TSA-60-S	5-0 X 3-6 X 1-7	-	-	SS-304	1/2" IPS	* 12" side boards; 7" backsplash; includes Faucet Includes Grate
2	Floor Sink	2	Zurn	Z1900	1-0 X 0-6 X 1-0	-	-	SS-304	3/8" IPS	
3	Prep Sink	1	Advanced Tabco	FS-1-1818-18L	38-2.5 X 0-9 X 0-9	X	X	SS-304	1/2" IPS	* 8-1/2" SS Backsplash
4	Hand Wash Sink	1	Advanced Tabco	PS-22	2-3 X 2-3 X 2-3	X	X	SS-304	3/8" IPS	
5	Faucet Set	1	T&S		2-0 X 4-0	X	X	-	-	
6										
(X)										
A	Water Heater	1	Stiebel Eltron	Mini 2-1	7 1/2 X 73-1/8 X 35-5/8	X	X	ELEC	16 AMPS	* 3.5 lbs; hardwire; 12AWG; Tankless; Dedicated Circ.
B	Wine Cooler	1	True	TBB-24-72G-SD	24-1/2 X 24-1/2 X 24-1/2	X	X	ELEC	5.2 AMPS	* Confirm clearances at back bar counter
-										

\* Provided by owner, Installed by Contractor

MANUFACTURER OF EQUIPMENT CHANGED BY OWNER (as-built)

# REFERENCE NOTES

- 00.100 Signs - see notes
- 00.110 Wall Below or Beyond
- 00.130 Soffit, Overhang or Object Above
- 00.131 Cabinet or Shelf Above
- 00.132 Beam Above
- 00.135 Opening Above
- 00.320 Stair/Steps- see Plans, Notes & Details
- 00.325 Accessible Ramp- max. 1:12 slope
- 00.400 Detectable Warning Surface (see Site Plan Notes)
- 00.500 Column- see Plans, Notes & Details
- 00.600 Coordinate Dimension, Location & Other Requirements w/ Manufacturer, Fabricator or Architect as required
- 00.620 Center on Fixture, Open', Wall, Object, Existing, Etc.
- 00.625 Center Line- Street, Open'g, Beam, Col., Object, Etc.
- 00.630 Attic Access-Min. 32" clear opening w/ self closing hinges
- 02.441
- 03.302 Concrete Curb- see Details
- 03.303 Concrete Footing
- 03.315 Concrete Slab
- 04.210 Masonry Walls
- 05.100 Steel Column- see Structural
- 05.520 Metal Handrail
- 05.720
- 06.120 2 x 4 Stud Framing @ 16" o.c. (uno)
- 06.160 Plywood- size as noted
- 06.192 Wood Screw- Stainless Steel- size as noted
- 06.193 Lag Bolt, H.D. Galv. When Exposed- size as noted
- 06.194 Bolt, Stainless Steel When Exposed- size as noted
- 06.195 Anchor Bolt- size as noted
- 06.401 #1 Construction Grade Douglas Fir, Dry (size as noted or see details)
- 06.410 Counter Top- see interior elevations
- 06.416 Plastic Laminate Counter Top- see interior elevations
- 06.669 Composite Quartz Surfacing
- 07.200 Thermal Insulation- see Floor Plan Notes
- 07.649 Galvanized Sheet Metal
- 08.116 Aluminum Frame Door
- 08.433 Aluminum Frame Storefront
- 08.600 Window- see Schedules & Notes
- 08.721 Threshold (see door schedule, notes & details)
- 09.225 Gypsum Board- see Notes
- 09.226 Metal Studs- see Floor Plan Notes & Dtl 13-16, A8.3
- 09.320 Ceramic Tile
- 09.321 Ceramic Tile, Decorative
- 09.319 Quarry Tile & Quarry 6" Cove Tile
- 09.641 Wood Composition Flooring
- 09.643 Transition Strip- see Floor Plan Notes
- 09.656 Resilient Sheet Flooring- see Floor Plan Notes
- 09.659 Vinyl Tile- see Floor Plan Notes
- 09.663 Rubber Base, 4" High
- 10.147 Display Case
- 11.220 Under Counter Display Cooler
- 12.359 Display Cases
- 21.133 Fire Sprinkler Riser Pipes (existing)
- 22.320 Water Filter System
- 22.341 Water Heater, Instantaneous- see Appliance schedule
- 22.410 Plumbing Fixture- see schedule
- 23.750 Roof Mounted HVAC (existing)- see mechanical plans
- 26.090 Electrical Meter, House Shut-off Switch, & Grounding
- 26.091 House Sub-panel
- 26.510 Light Fixture
- 27.050 Data, Satellite & Telephone Distribution Equipment

# AS-BUILT

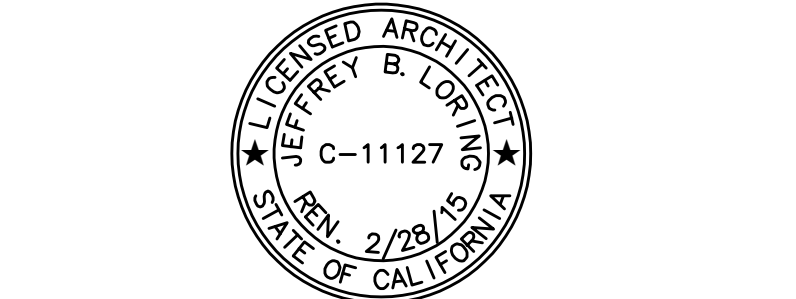

**JEFFREY LORING ARCHITECT**  
 2747 EL CERRITO SAN LUIS OBISPO, CALIFORNIA 93401  
 805.550.6007

project name: **TASTE in the alley**  
 project location: 1211 PINE STREET PASO ROBLES CALIFORNIA  
 project owner: ASH MEHTA and LISSA HALLBERG 911 PRICE STREET, suite A PISMO BEACH 93449

sheet title: **DIMENSION & MATERIAL PLANS**  
 date: 04/09/14 job no: 131103  
 rev's:  
 sheet number: **A 2.1**  
 california license no: 011127

