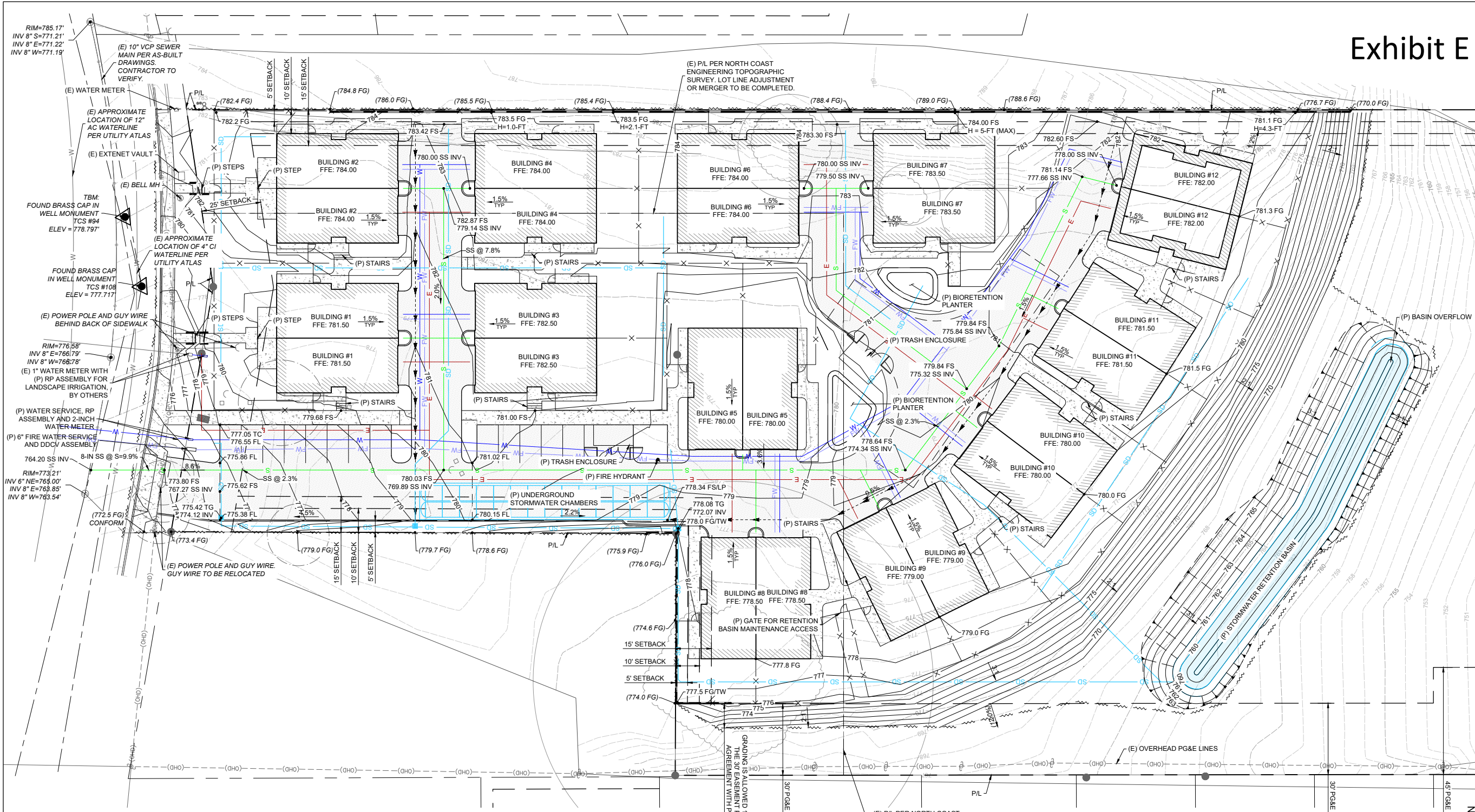

Exhibit E



GENERAL NOTES:

ALL EXISTING UTILITIES SHOWN ARE BASED ON THE BEST AVAILABLE INFORMATION. CONTRACTOR TO POTHOLE ALL POINTS OF CONNECTION AND VERIFY ALL CLEARANCES. MATERIAL DEPTH AND LOCATION SHALL BE IDENTIFIED BY CONTRACTOR. IF THERE ARE ANY DIFFERENCES FROM PLAN WITH ANY OF THESE ITEMS, ENGINEER OF WORK SHALL BE NOTIFIED IMMEDIATELY.

TOPOGRAPHIC AND BOUNDARY INFORMATION PROVIDED BY: NORTH COAST ENGINEERING, JUNE 2024

A PROPOSED RETAINING WALL ALONG THE EASTERLY PROPERTY LINE WILL PREVENT THE PROJECT FROM RECEIVING STORMWATER RUN-ON FROM THE NEIGHBORING SUBDIVISION TO THE EAST.

POST-CONSTRUCTION STORMWATER NOTES:

1. THE PROJECT SITE IS LOCATED IN WMZ 1.
2. THE PROJECT WILL CREATE OR REPLACE MORE THAN 22,500 SF OF IMPERVIOUS SURFACING.
3. THE PROJECT WILL DISTURB APPROXIMATELY 2.6 AC.
4. THE PROJECT IS REQUIRED TO RETAIN THE 95TH PERCENTILE STORM EVENT.

FLOOD CONTROL NOTES:

1. THE PROJECT, IN ITS FULLY DEVELOPED CONDITION, IS REQUIRED TO MATCH THE PREDEVELOPMENT STORMWATER PEAK FLOWS UP TO THE 100-YEAR, 24-HOUR STORM EVENT.

UTILITY NOTES:

1. UTILITY CONNECTIONS TO BE PROVIDED FOR EACH UNIT (24 TOTAL UNITS) INCLUDING DOMESTIC WATER SUBMETERS.
2. ALL UTILITIES ON SITE WILL BE PRIVATELY MAINTAINED, AND ALL OTHER UTILITIES IN THE RIGHT-OF-WAY WOULD BE MAINTAINED BY THE CITY OF PASO.

GRADING INFORMATION NOTES:

CUT QUANTITY: 1000 CUBIC YARDS
FILL QUANTITY: 8000 CUBIC YARDS
NET QUANTITY: 7000 CUBIC YARDS IMPORT

*NOTE: THE ABOVE QUANTITIES ARE FOR PLANNING AND PERMITTING PURPOSES ONLY. SHRINKAGE, CONSOLIDATION AND SUBSIDENCE FACTORS; LOSSES DUE TO CLEARING AND DEMOLITION OPERATIONS; AND TRENCHING FOR UTILITIES AND FOUNDATIONS ARE NOT INCLUDED. ESTIMATED EARTHWORK QUANTITIES ARE BASED ON THE APPROXIMATE DIFFERENCE BETWEEN EXISTING GRADES AND PROPOSED FINISHED GRADES OR PAVEMENT SUBGRADES, AS INDICATED ON THE PLANS, AND SHOULD VARY ACCORDING TO THESE FACTORS AND LOSSES. THE CONTRACTOR SHALL PERFORM AN EARTHWORK ESTIMATE FOR THE PURPOSE OF PREPARING A LUMP SUM BID PRICE FOR EARTHWORK. THE BID PRICE SHALL INCLUDE COSTS FOR ANY NECESSARY IMPORT AND PLACEMENT OF EARTH MATERIALS OR THE EXPORT AND PROPER DISPOSAL OF EXCESS EARTH MATERIALS.

RETAINING WALL INFORMATION:

RETAINING WALL ALONG EAST PROPERTY LINE

LENGTH: 340 FT
MAX HEIGHT: 5 FT (CUT)

RETAINING WALL ALONG WEST PROPERTY LINE:

LENGTH: 110 FT
MAX HEIGHT: 4 FT (FILL)

LEGEND

- W — W — (P) WATER LINE
- FW — FW — (P) FIREWATER LINE
- S — S — (P) SEWER LINE
- E — E — (P) ELECTRICAL LINE
- SD — SD — (P) STORMDRAIN
- X — X — X — (P) FENCE

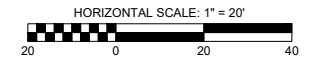

Plan Prepared By:

Engineer of Record:



420 CRESTON ROAD
420 CRESTON
PASO ROBLES, CA 93446

1ST ENTITLEMENT SUBMITTAL - NOT FOR CONSTRUCTION

Revisions:

1	
2	
3	
4	

Project Engineer: EMD Ext: 141
Project Manager: KEA
Date: 11/14/2025 Scale: PER PLAN
AV Job No: 240621 Sheet Size: 24" x 36"

PRELIMINARY
GRADING AND
DRAINAGE PLAN

C-2.1